



FOUNTAIN PAJOT ALEGRIA 67

S/Y NEOW

LUXURY, REFINEMENT & PERFORMANCE



With a waterline length of over 20 metres,  
the luxury catamaran NEOW is equipped to match  
her size and her status as a true yacht.

Her aesthetics are transcended to create  
a sailing experience where comfort and sophistication  
are harmoniously combined.



Designed to break free of all limits  
and conventions for those who want to go far...  
Welcome aboard!



Among her remarkable original features, the centrepiece of the boat is in the forward cockpit: a large Jacuzzi, which you can fill with sea water or fresh water, as you wish...



A huge 37 m<sup>2</sup> flybridge for more conviviality.





Indoor or outdoor, NEOW boasts wide spaces and volumes to share memorable moments.







Carefully thought out and refined interior design bathed in natural light.







The open kitchen is equipped with the latest technology, top-of-the-range appliances and intelligent storage. A functional & convivial space to share unforgettable culinary moments.



An elegant 22 m<sup>2</sup> suite offering a haven  
of peace and privacy.



Each cabin is furnished with style  
and attention to detail.







# EQUIPMENT OF NEOW

## ACCOMMODATION

Up to 8 guests in 4 double cabins fully air conditioned with ensuite bathrooms

3 crew members in separate compartments : Captain, Deckhand and Chef-Stewardess

## GENERAL AMENITIES

WiFi, Luxury outdoor area with shade, Swimming hydraulic, platform and ladder, Jacuzzi

## TENDERS AND TOYS

Semi rigid tender GALA 4.5 meters with 60 HP Suzuki | Water ski - size 36 to 47

3 sea scooters Jobe Infinity | 1 wakeboard | 3 paddles | 1 surf electric Jobe rumble 1 person

1 Towing ring | Noodles | Snorkeling equipment for 8

Rendez vous diving only

## OTHER AMENITIES

Cockpit, roof & deck cushions | Cockpit table | Speakers connected to lounge HI-FI set

Cockpit lights | Electric Windlass | Shade cloth for front beach living room | Large sofas in the salon master cabin

Water maker: 1 x 200 L / hour | Hot water tanks / Ballons d'eau chaude : yes 2 | Deep freezer & Refrigeration

Plancha | Espresso coffee machine | Wine cellar | Water purifier with water fountain

## COMMUNICATIONS

Radio sound in saloon with speakers inside, at cockpit and 4 ones at the flybridge | TV in the saloon

WiFi connection on board / Internet / e-mail

# SPECIFICATIONS

**Architects** Berret Racoupeau Yacht design

**Launch** 2024 | **Builder** Fontaine Pajot | **Materials** Fiberglass | **LOA** 20,4m (67ft) | **Beam** 9,8m | **Draft** 1,7m

**Fuel capacity** 1200 l

## GENERAL ARRANGEMENT

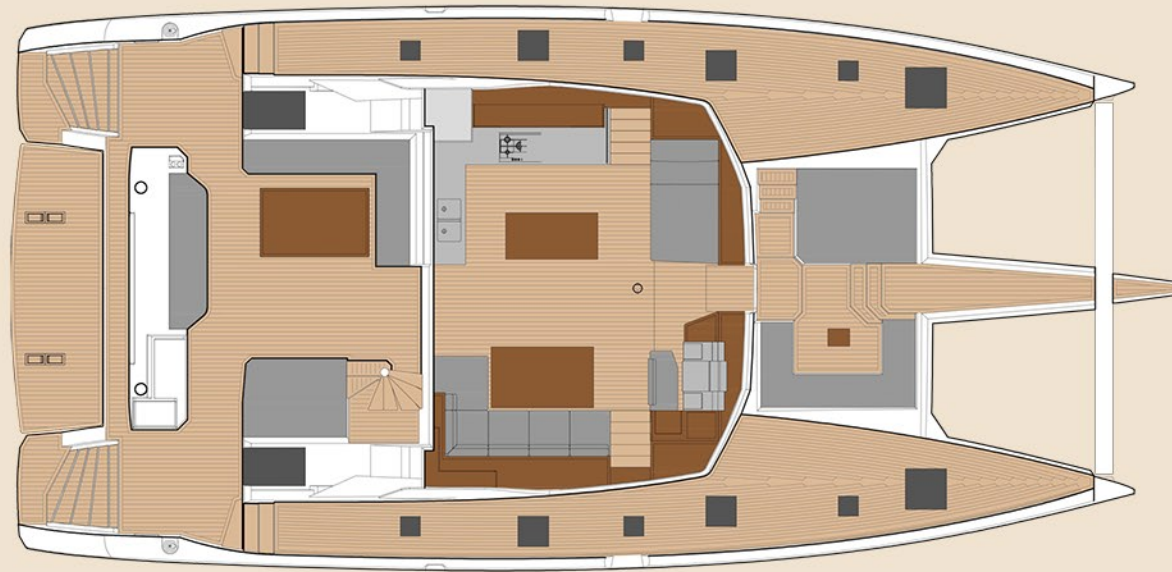



Credit photo : Alberto Bravo Gil

This document is not contractual. All specifications are given in good faith and offered for informational purposes only. The publisher and company do not warrant or assume any legal liability or responsibility for the accuracy, completeness, or usefulness of any information and/or images displayed. Yacht inventory, specifications and charter prices are subject to change without prior notice. None of the text and/or images used in this brochure may be reproduced without written consent from the publisher.